

PRELIMINARY - NOT FOR CONSTRUCTION

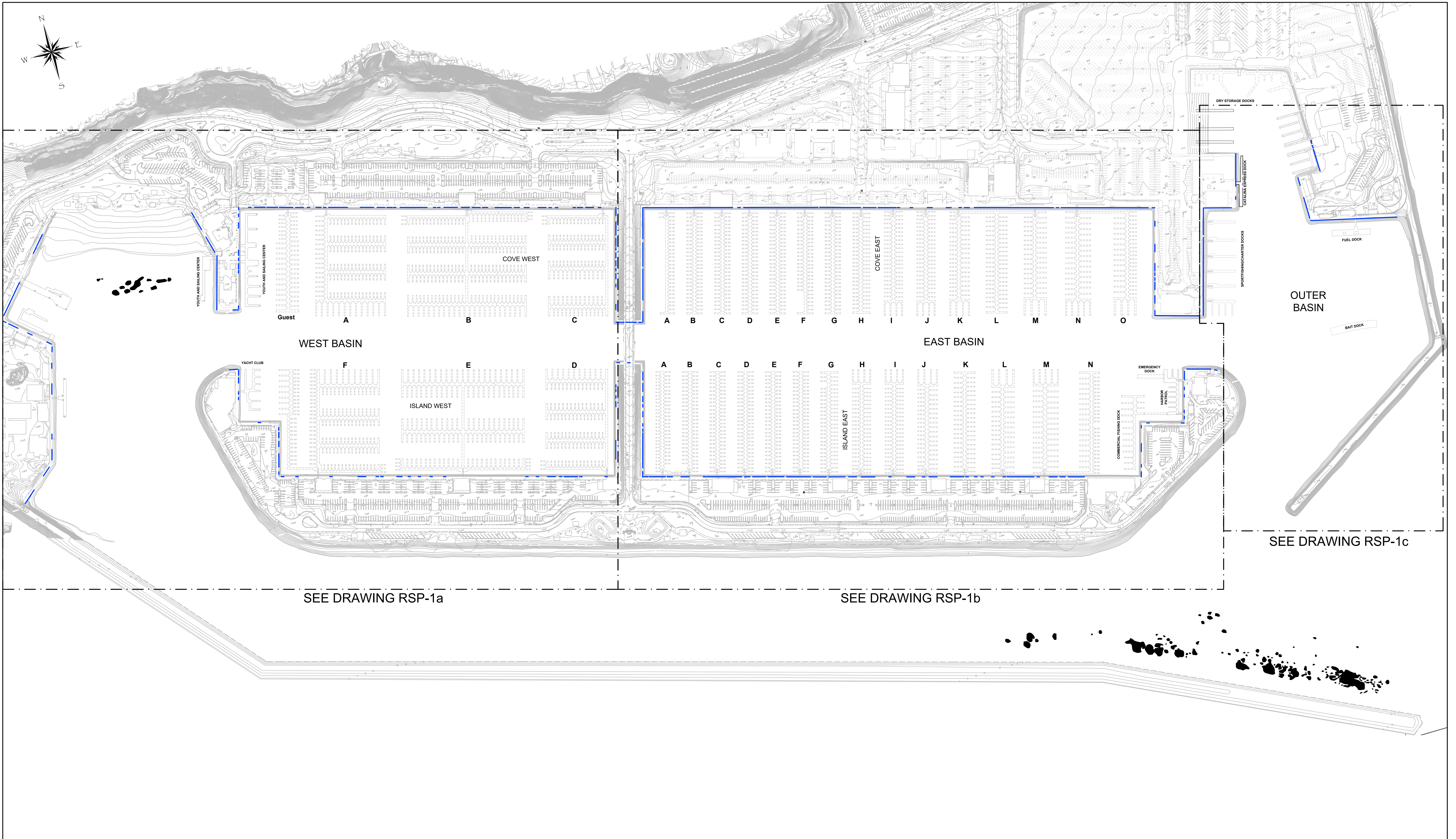

NO.	DATE	DESCRIPTION	BY
REVISIONS			

Bellingham MARINE
 THE WORLD'S MOST COMPREHENSIVE MARINA BUILDER

SOUTHWEST DIVISION
 CA LICENSE #442499
 8810 SPARLING LANE
 DIXON, CA 95620
 TEL: (707) 678-2385
 FAX: (707) 678-1760

THIS DRAWING CONTAINS PROPRIETARY INFORMATION WHICH IS THE PROPERTY OF BELLINGHAM MARINE INDUSTRIES, INC. AND SHALL NOT BE COPIED, REPRODUCED OR MADE AVAILABLE TO THIRD PARTIES WITHOUT PRIOR WRITTEN PERMISSION FROM BELLINGHAM MARINE INDUSTRIES, INC. UNIFLOAT®, UNIDECK® AND © BELLINGHAM MARINE INDUSTRIES, INC.

PROJECT NUMBER: 7109/7182
ENGINEER / DESIGNER:
PROJECT MANAGER:
CHECKED BY:

DANA POINT HARBOR REVITALIZATION
 ALL AREAS (EAST, WEST, OUTER BASINS, LAUNCH AREA)
 Dana Point, CA

SITE PLAN (Overall)-
 SEAWALL REPAIR (Repair Type 1)

SCALE:	1"=160' (Sheet Size 24" x 36")
DRAWN BY:	DD
DATE:	10-9-19
DRAWING:	RSP-1
SHEET NO.:	

PRELIMINARY - NOT FOR CONSTRUCTION

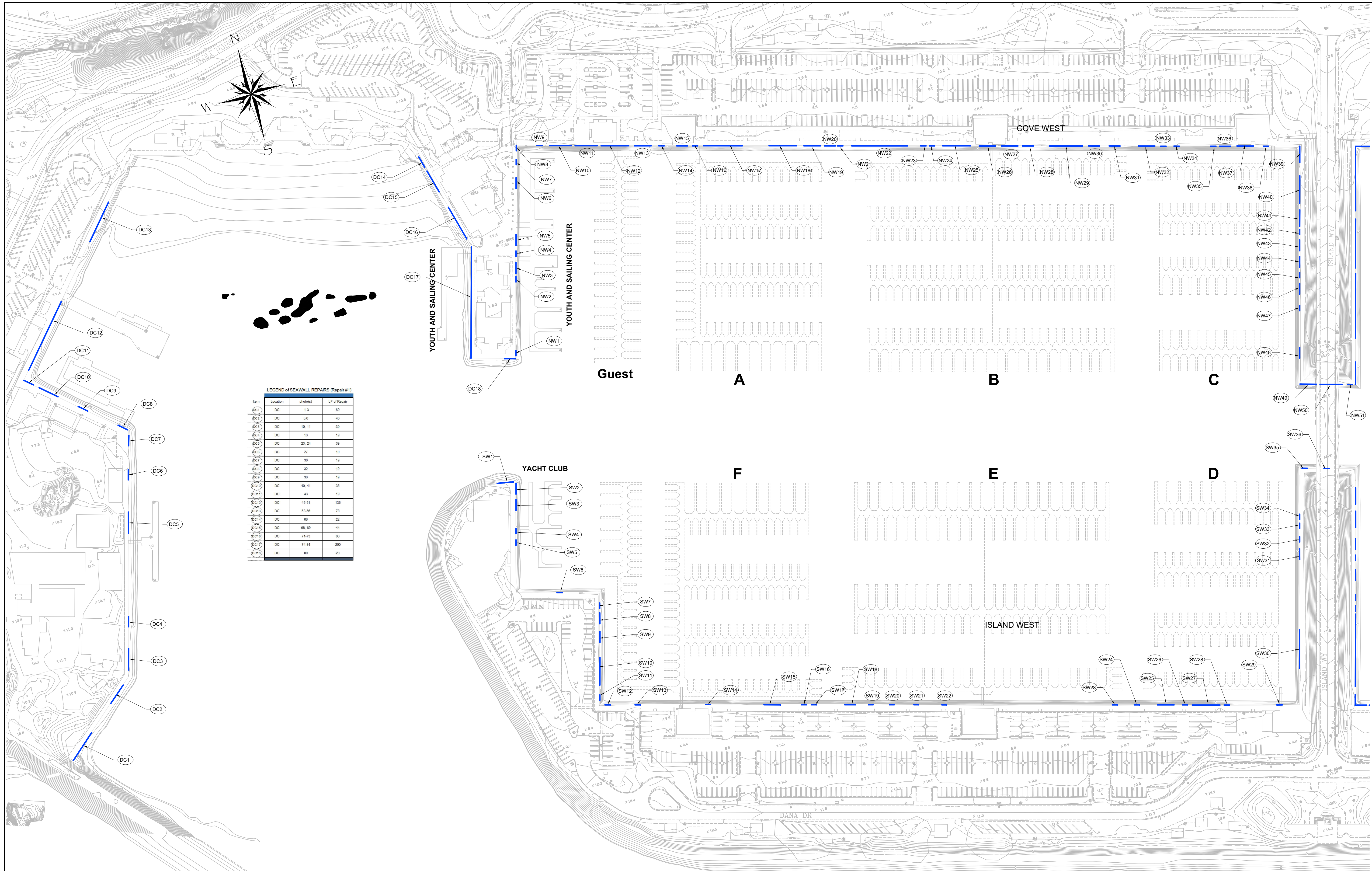

LEGEND of SEAWALL REPAIRS (Repair #1)

Item	Location	photo(s)	LF of Repair
DC1	1-3		60
DC2	5-8		40
DC3	10, 11		39
DC4	13		19
DC5	23, 24		39
DC6	27		19
DC7	30		19
DC8	32		19
DC9	36		19
DC10	40, 41		38
DC11	43		19
DC12	45-51		136
DC13	53-56		78
DC14	66		22
DC15	68, 69		44
DC16	71-73		66
DC17	74-84		200
DC18	88		20

LEGEND of SEAWALL REPAIRS (Repair #1)

Item	Location	photo(s)	LF of Repair
NW1	NW	2	10
NW2	NW	12	10
NW3	NW	14, 15	20
NW4	NW	17	10
NW5	NW	19, 20	20
NW6	NW	25, 26	20
NW7	NW	32	10
NW8	NW	36	10
NW9	NW	40	10
NW10	NW	42-45	40
NW11	NW	47-50	40
NW12	NW	52-55	50
NW13	NW	58-60	30
NW14	NW	62	10
NW15	NW	65, 66	20
NW16	NW	68	10
NW17	NW	70, 71	20
NW18	NW	80-84	50
NW19	NW	85-88	30
NW20	NW	91, 92	20
NW21	NW	94	10
NW22	NW	95-105	100
NW23	NW	108	10
NW24	NW	110	10
NW25	NW	112-116	50
NW26	NW	118-120	30
NW27	NW	122-124	30
NW28	NW	126, 127	20
NW29	NW	130-135	60
NW30	NW	137, 138	20
NW31	NW	141, 142	20
NW32	NW	145-148	30
NW33	NW	150	10
NW34	NW	152	10
NW35	NW	161	10
NW36	NW	163, 164	20
NW37	NW	168-170	30
NW38	NW	172	10
NW39	NW	178-180	30
NW40	NW	183-187	50
NW41	NW	189-191	30
NW42	NW	193	10
NW43	NW	195, 196	20
NW44	NW	198, 199	20
NW45	NW	201	10
NW46	NW	203-204	20
NW47	NW	206	10
NW48	NW	212, 213	20
NW49	NW	219-221	30
NW50	NW	223-226	40
NW51	NW	228	10

LEGEND of SEAWALL REPAIRS (Repair #1)

Item	Location	photo(s)	LF of Repair
SW1	SW	230-237	30
SW2	SW	233, 234	20
SW3	SW	229, 230	20
SW4	SW	226	10
SW5	SW	224	10
SW6	SW	209	10
SW7	SW	196	10
SW8	SW	193, 194	20
SW9	SW	190, 191	20
SW10	SW	183-187	50
SW11	SW	180	10
SW12	SW	177	10
SW13	SW	171	10
SW14	SW	158	10
SW15	SW	145-147	30
SW16	SW	141	10
SW17	SW	139	10
SW18	SW	133, 134	20
SW19	SW	129	9
SW20	SW	126	9
SW21	SW	123	9
SW22	SW	117	9
SW23	SW	87	10
SW24	SW	83	10
SW25	SW	78-80	30
SW26	SW	75	10
SW27	SW	68-73	50
SW28	SW	67	10
SW29	SW	58	10
SW30	SW	42-48	60
SW31	SW	30, 31	20
SW32	SW	27	10
SW33	SW	23	10
SW34	SW	21	10
SW35	SW	9	10
SW36	SW	5	10

NO.	DATE	DESCRIPTION	BY
REVISIONS			

Bellingham MARINE
 THE WORLD'S MOST COMPREHENSIVE MARINA BUILDER

SOUTHWEST DIVISION
 CA LICENSE #442499
 8810 SPARKLING LANE
 DIXON, CA 95620
 TEL: (707) 678-2385
 FAX: (707) 678-1760

THIS DRAWING CONTAINS PROPRIETARY INFORMATION WHICH IS THE PROPERTY OF BELLINGHAM MARINE INDUSTRIES, INC. AND SHALL NOT BE COPIED, REPRODUCED OR MADE AVAILABLE TO THIRD PARTIES WITHOUT PRIOR WRITTEN PERMISSION FROM BELLINGHAM MARINE INDUSTRIES, INC. UNIDECK® AND © BELLINGHAM MARINE INDUSTRIES, INC.

PROJECT NUMBER:
7109/7182

ENGINEER / DESIGNER:

PROJECT MANAGER:

CHECKED BY:

DANA POINT HARBOR REVITALIZATION
 ALL AREAS (EAST, WEST, OUTER BASINS, LAUNCH AREA)
 Dana Point, CA

SEAWALL REPAIR (Repair Type 1)-
 DANA COVE, EAST BASIN

SCALE: 1" = 80'
 (Sheet Size 24" x 36")

DRAWN BY: DD

DATE: 10-10-19

DRAWING: RSP-1a

SHEET NO.:

PRELIMINARY - NOT FOR CONSTRUCTION

Item	Location	photo(s)	LF of Repair
NE1	NE 14		40
NE2	NE 9-20		116
NE3	NE 22-30		88
NE4	NE 32-43		116
NE5	NE 44-78		333
NE6	NE 80		10
NE7	NE 82-110		276
NE8	NE 112-127		152
NE9	NE 129-133		48
NE10	NE 135-141		66
NE11	NE 143		10
NE12	NE 148		10
NE13	NE 155, 156		19
NE14	NE 162, 163		19
NE15	NE 165		10
NE16	NE 166, 169		19
NE17	NE 172, 202		294
NE18	NE 204		10
NE19	NE 209-239		323
NE20	NE 241		10
NE21	NE 250-251		19
NE22	NE 258-260		28
NE23	NE 266-268		20
NE24	NE 270		10
NE25	NE 272		10
NE26	NE 274-276		28
NE27	NE 278-280		19
NE28	NE 282, 283		19
NE29	NE 284-288		167

Item	Location	photo(s)	LF of Repair
SE1	SE 267, 269		30
SE2	SE 263-265		30
SE3	SE 280, 281		30
SE4	SE 277		10
SE5	SE 274-275		30
SE6	SE 271		10
SE7	SE 269		10
SE8	SE 255-267		130
SE9	SE 252-253		20
SE10	SE 250-251		20
SE11	SE 243-248		60
SE12	SE 240-241		20
SE13	SE 231-233		30
SE14	SE 227		10
SE15	SE 213-225		130
SE16	SE 210-211		30
SE17	SE 204-208		50
SE18	SE 197-202		60
SE19	SE 187-195		90
SE20	SE 181-185		50
SE21	SE 174-179		60
SE22	SE 170-172		30
SE23	SE 164-166		50
SE24	SE 156		10
SE25	SE 146-150		30
SE26	SE 144		10
SE27	SE 136-141		30
SE28	SE 130-134		50
SE29	SE 128		10
SE30	SE 125		10
SE31	SE 123		10
SE32	SE 119		10
SE33	SE 115		10
SE34	SE 104-113		100
SE35	SE 102		10
SE36	SE 96-98		30
SE37	SE 93-94		20
SE38	SE 86-91		60
SE39	SE 63-64		20
SE40	SE 61		10
SE41	SE 53-55		30
SE42	SE 47		10
SE43	SE 44		10
SE44	SE 30		10
SE45	SE 27		10
SE46	SE 25		10
SE47	SE 21		10
SE48	SE 19		10
SE49	SE 12-14		30
SE50	SE 3-8		89
SE51	SE 1		10

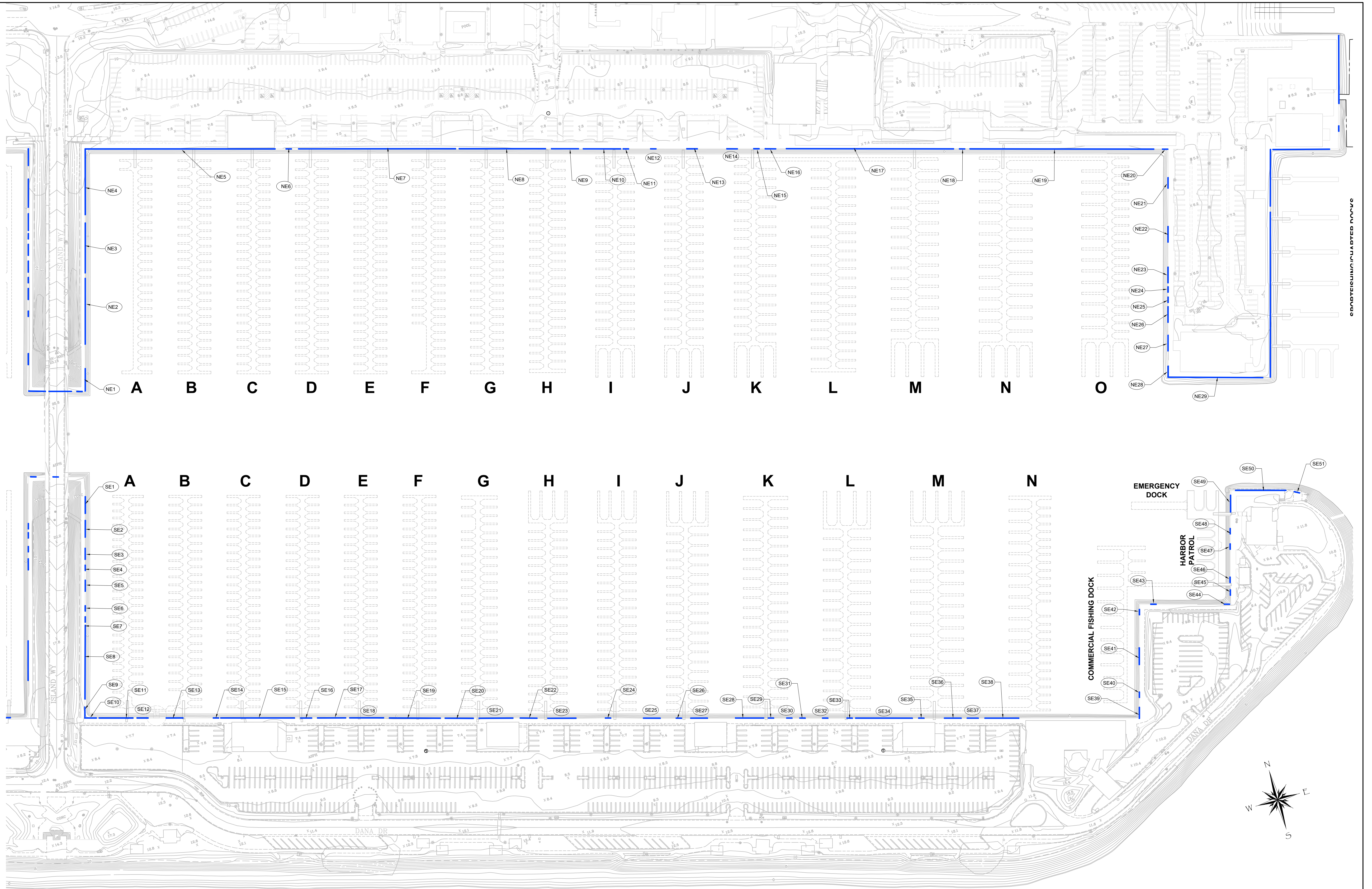

NO.	DATE	DESCRIPTION	BY

Bellingham MARINE
 THE WORLD'S MOST COMPREHENSIVE MARINA BUILDER

SOUTHWEST DIVISION
 CA LICENSE #442499
 8810 SPARLING LANE
 DIXON, CA 95620
 TEL: (707) 678-2385
 FAX: (707) 678-1760

THIS DRAWING CONTAINS PROPRIETARY INFORMATION WHICH IS THE PROPERTY OF BELLINGHAM MARINE INDUSTRIES, INC. AND SHALL NOT BE COPIED, REPRODUCED OR MADE AVAILABLE TO THIRD PARTIES WITHOUT PRIOR WRITTEN PERMISSION FROM BELLINGHAM MARINE INDUSTRIES, INC. UNIFLOAT® UNIDECK® AND © BELLINGHAM MARINE INDUSTRIES, INC.

PROJECT NUMBER: 7109/7182
ENGINEER / DESIGNER:
PROJECT MANAGER:
CHECKED BY:

DANA POINT HARBOR REVITALIZATION
 ALL AREAS (EAST, WEST, OUTER BASINS, LAUNCH AREA)
 Dana Point, CA

SEAWALL REPAIR (Repair Type 1)-
 WEST BASIN

SCALE: 1" = 80' (Sheet Size 24" x 36")
DRAWN BY: DD
DATE: 10-10-19
DRAWING: RSP-1b
SHEET NO.:

PRELIMINARY - NOT FOR CONSTRUCTION

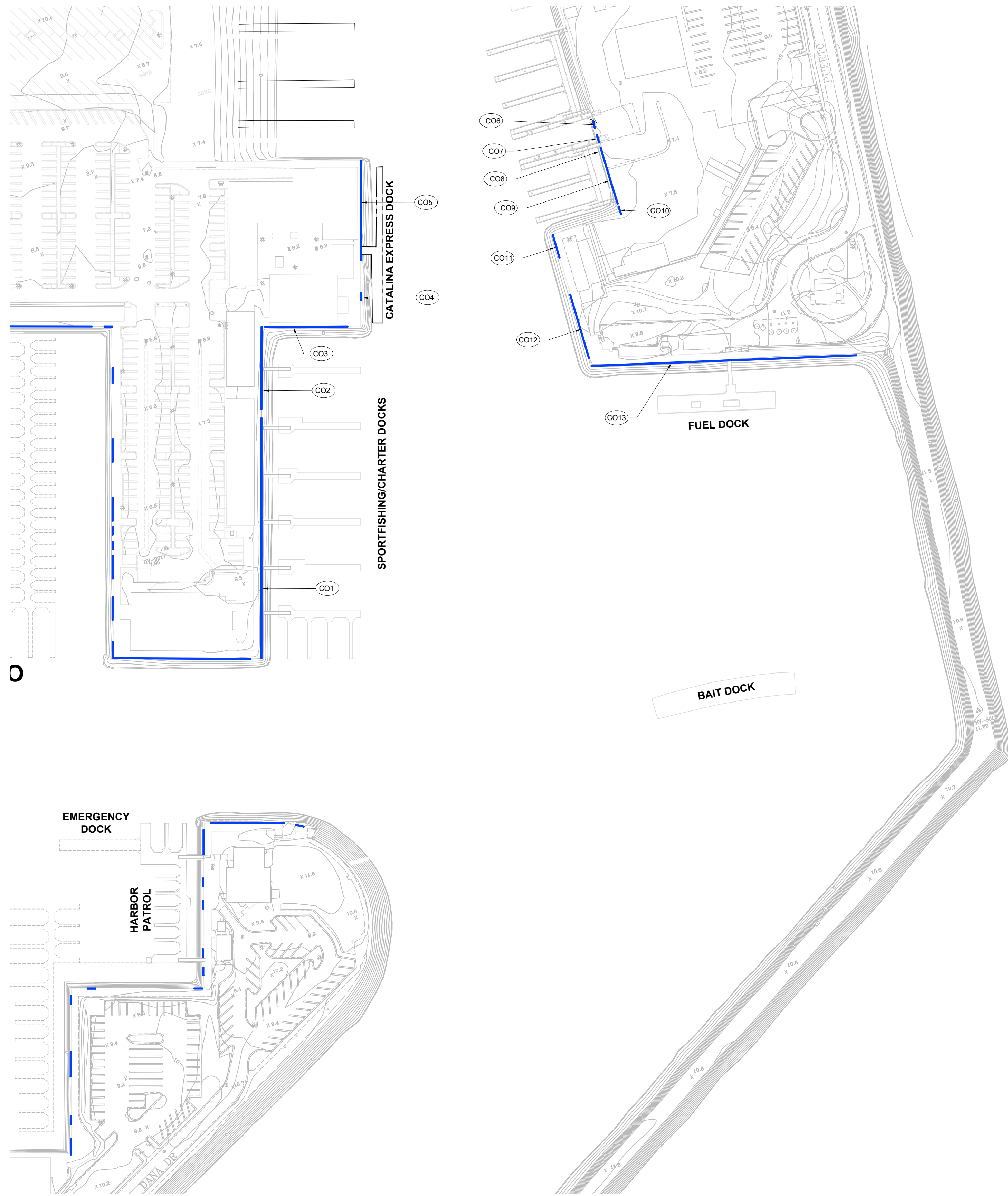

LEGEND of SEAWALL REPAIRS (Repair #1)

Item	Location	photo(s)	LF of Repair
CO1	CO	1-29	290
CO2	CO	31-41	100
CO3	CO	43-50	100
CO4	CO	53	10
CO6	CO	61-72	120
CO8	CO	148	10
CO7	CO	151	10
CO8	CO	153-157	50
CO9	CO	159-160	20
CO10	CO	164	10
CO11	CO	174-175	30
CO12	CO	177-183	80
CO13	CO	184-202	320

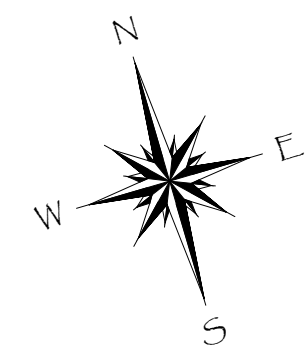

NO.	DATE	DESCRIPTION	BY
REVISIONS			



SOUTHWEST DIVISION
CA LICENSE #442499
8810 SPARLING LANE
DIXON, CA 95620
TEL: (707) 678-2385
FAX: (707) 678-1760

THIS DRAWING CONTAINS PROPRIETARY INFORMATION WHICH IS THE PROPERTY OF BELLINGHAM MARINE INDUSTRIES, INC. AND SHALL NOT BE COPIED, REPRODUCED OR MADE AVAILABLE TO THIRD PARTIES WITHOUT PRIOR WRITTEN PERMISSION FROM BELLINGHAM MARINE INDUSTRIES, INC. UNIFLOAT® UNIDECK® AND © BELLINGHAM MARINE INDUSTRIES, INC.

PROJECT NUMBER:
7109/7182

ENGINEER / DESIGNER:

PROJECT MANAGER:

CHECKED BY:

DANA POINT HARBOR REVITALIZATION
ALL AREAS (EAST, WEST, OUTER BASINS, LAUNCH AREA)
Dana Point, CA

SEAWALL REPAIR (Repair Type 1)-
OUTER BASIN (COMMERCIAL)

SCALE: 1" = 80'
(Sheet Size 24" x 36")

DRAWN BY: DD

DATE: 10-10-19

DRAWING: RSP-1c

SHEET NO.: